

7-9 John Street North Fremantle,
Western Australia 6159

P: +61 (0) 8 9336 2555
F: +61 (0) 8 9336 2140
reservations@pier21.com.au
www.pier21.com.au

NEARBY ATTRACTIONS

Leighton Beach
Fremantle Maritime Museum
Fremantle Markets
Fishing Boat Harbour

Cappuccino Strip on South Terrace
Round House and Whalers Tunnel
Rottnest Island Ferry Terminal

DISTANCE FROM

Domestic Airport: 26kms
International Airport: 28kms
The City of Fremantle: 3kms
Perth CBD: 16 kms
Australian Marine Complex: 15 kms

LOCATION

Pier 21 Apartment Hotel is superbly positioned on the banks of the Swan River, ideally situated for business or leisure travellers, just minutes from the City of Fremantle, public transport, beaches and local attractions.



Welcome...



Features

Pier 21 Apartment Hotel is superbly positioned on the banks of the Swan River in the prestigious area of North Fremantle, offering a choice of 47 self contained and serviced suites and apartments, most with panoramic views overlooking the Swan River.

GUEST SERVICES

- Complimentary car parking
- Daily housekeeping service
- Reception open from 7am – 9pm
- After hours key collection available
- Central guest laundry
- Valet dry cleaning and laundry
- Extensive mini-bar menu with gourmet meals
- Wheelchair accessible features

HOTEL FACILITIES

- State of the art fitness centre
- Heated indoor pool and spa
- Outdoor pool
- BBQ facilities
- Tennis court
- Recreational paths alongside the Swan River
- Breakfast lounge

RESTAURANT

The Pier 21 Breakfast Lounge is warm and inviting, offering the choice of buffet or continental breakfast.

MEETING & FUNCTION FACILITIES

Pier 21 Conference Room caters for up to 15 delegates and features natural light. All meeting room hire is inclusive of whiteboard, flipchart, pads, pens, mints and bottled water. Additional audio-visual equipment and presentation aids are available on request. Day delegate packages and menus are available.

Guestrooms

EXECUTIVE STUDIO APARTMENT

Average size 37m²

- Well-equipped kitchenette with full size fridge, microwave, hotplates and dishdrawer
- Queen bed
- Executive desk with multimedia connectivity
- Italian leather lounge
- 42 inch LCD TV with movies on-demand
- Wi-Fi and high-speed cable internet
- ISDN/STD Telephone
- Individually controlled air-con and heating
- Furnished balcony

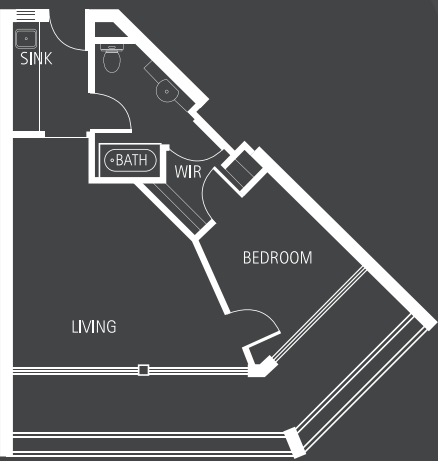

EXECUTIVE ONE BEDROOM APARTMENT

Average size 52m²

- Well-equipped kitchenette with full size fridge, microwave, hotplates and dishdrawer
- Spacious bedroom with queen bed
- Executive desk with multimedia connectivity
- Italian leather lounge, dining table and chairs
- 42 inch LCD TV with movies on-demand
- Wi-Fi and high-speed broadband internet
- ISDN/STD Telephone
- Individually controlled air-con and heating
- Separate living area with furnished balcony

EXECUTIVE TWO BEDROOM APARTMENT

Average size 55m²

- Choice of 2 queen beds or 1 queen and two king single beds
- Well-equipped kitchenette with full size fridge, microwave, hotplates and dishdrawer
- Executive desk with multimedia connectivity, Italian leather lounge, dining table and chairs
- 42 inch LCD TV with movies on-demand
- 32 inch LCD TV in second bedroom
- Wi-Fi and high-speed cable internet
- ISDN/STD Telephone
- Individually controlled air-con and heating
- Separate living area with furnished balcony

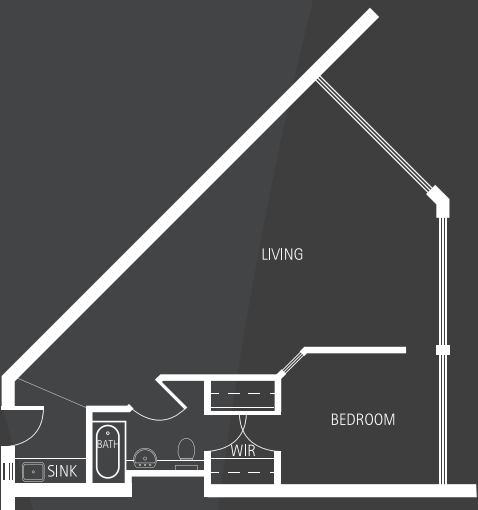

RIVERSIDE SUITE

Average size 74m²

- Well-equipped kitchenette with full size fridge, microwave, hotplates and dishdrawer
- Spacious bedroom with king bed
- Rain shower with stone feature wall
- Nespresso coffee maker
- iPod Dock
- Executive desk with multimedia connectivity
- Italian leather lounge with day bed, dining table and chairs
- 50 inch Plasma with movies on-demand
- 32 inch LCD TV in the master bedroom
- Separate living area with furnished balcony and river views

